

Revision History / Revizyon Tarihiçesi					
No Nu.	Date Tarih	Request No Talep Nu.	Revision Revizyon	Realised By Gerçekleştiren	Approved By Onaylayan
C	04.09.2018	1476	Alt conta sertliği 60 Shore olarak değiştirildi.	Ahmet ERDOĞAN	Tolga Yaroğlu
B	30.08.2018	1465	Yeni parça eklendi.	Ahmet ERDOĞAN	Tolga Yaroğlu

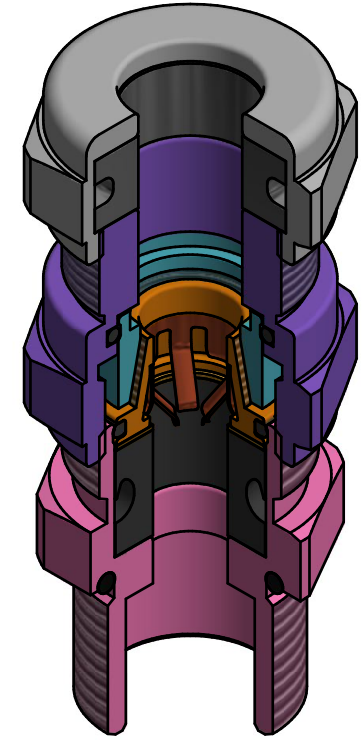

CABLE CLAMPING RANGE

Upper Seal: Ø6.0 - Ø12.0mm

Lower Seal: Ø3.0 - Ø8.0mm

12	1	ORION LEAD SHEATH METAL WASHER (3.0-8.5)	Brass (Nickel Plated), Stainless Steel
11	1	ORION LEAD SHEATH CONTACT SPRING (3-8.5)	CuBe (Tin Plated)
10	1	O-RING Ø17x2.0	CR, MVQ (Silicone)
9	1	M16x1.5 Ex-db/eb ORION CAP (3-8.5)	Brass (Nickel Plated), Stainless Steel
8	1	M16x1.5 Ex-db/eb ORION UPPER SEALING (3-8.5)	CR, MVQ (Silicone)
7	1	M16x1.5 Ex-db/eb ORION UPPER BODY (3-8.5)	Brass (Nickel Plated), Stainless Steel
6	1	O-RING Ø17x1.5	CR, MVQ (Silicone)
5	1	M16x1.5 Ex-db/eb ORION SWIEL BRAID RING (3-8.5)	Brass (Nickel Plated), Stainless Steel
4	1	ORION LEAD SHEATH GROUNDING CONE (3-8.5)	Brass (Nickel Plated), Stainless Steel
3	1	O-RING Ø15x1.5	CR, MVQ (Silicone)
2	1	M16x1.5 Ex-db/eb LOWER SEAL (60 SHORE)	CR, MVQ (Silicone)
1	1	M20x1.5 Ex-db/eb ORION LOWER BODY (M16) (3-8.5)	Brass (Nickel Plated), Stainless Steel
ITEM	QTY	PART NUMBER	MATERIAL

Parts List

Drawing Number / Resim No	9530	Reference Number / Ref. No	-	Date / Tarih	14.07.2016
1st Discl. Request #/Y. Yn. Tal. No	-	Designed by / Tasarlayan	Ahmet ERDOĞAN	14.07.2016	
Bimed Code / Bimed Kodu	KBA1SM-LSK	Approved by / Onaylayan	Oğuz ELÇİ	-	Undefined Tolerances acc./to/ Belirtilmeyen Toleranslar (DIN 7168-f)
M20x1.5 Ex-db/eb ORION CABLE GLANDS (Lead Sheathed) TL16 (3-8.5)		M20x1.5 Ex-db/eb ORION RAKOR (Lead Sheathed) TL16 (3-8.5)		Materal / Malzeme	
				Nominal size ranges Anma ölçü aralıkları	Value Değer
				0.5s...s3	±0,05
				3<...s6	±0,05
				6<...s30	±0,10
				30<...s120	±0,15
				120<...s400	±0,20
bimed		Volume/Hacim	Mass / Ağırlık		
		N/A	N/A		